

CULITEK Back Bar Coolers-Standard Depth

Models: MBB-5928, MBB-6928, MBB-9028
MBB-5928G, MBB-6928G, MBB-9028G



MBB-6928



MBB-5928G

Back Bar Coolers-Standard Depth

Keep your drinks accessible with Back Bar Coolers from CULITEK. Designed for undercounter use or can double as a work surface. These standard depth coolers are available in solid or glass door configurations, offering great visibility and plenty of space to store your most popular brews! They are ideal for keeping beer "ice cold", until ready to serve! ETL Listed and ETL Sanitation, these units are backed with a 2-year warranty on parts and a 5-year warranty on the compressor. For areas where bar space is limited, narrow depth units also available.

Cooling System

- R290 hydrocarbon refrigerant is an environmentally-responsible choice for your business
- Condensing unit located behind front grill and slides out for easy cleaning
- Maintains a temperature range of 33°F to 41°F

Cabinet Construction

- Exterior is constructed of a durable black vinyl front and sides with an aluminum back
- Countertop is all stainless steel
- All stainless steel interior, floor, and walls
- Insulated cabinet with foamed-in-place, high density cell polyurethane insulation

Electrical Control

- Carel temperature controller initiates automatic defrost schedule for worry-free use
- 7-foot power cord with NEMA 5-15 plug

Door(s)

- Swing door-style with double pane thermal glass doors
- 12" long handles
- Positive seal doors
- Door locks on all models

Shelving

- Adjustable heavy-duty, PVC coated wire shelves
- Aluminum shelf support that are adjustable every 1/2"

Model Features

- Interior LED lighting provides greater visibility
- Stainless steel countertop is 1 1/2" thick

EQUIPMENT THAT DOMINATES
For Culinary Professionals

STANDARD FEATURES

- 304 stainless steel top, interior walls, and floor
- Exterior constructed of black steel with an aluminum back
- Balanced refrigeration system maintains temperature range of 33°F to 41°F
- Adjustable heavy-duty, PVC coated wire shelves
- Swing door-style with double pane thermal glass doors
- Side mounted compressor
- Foamed-in-place insulation helps provide strength, while helping to maintain internal temperature
- Eco-friendly R290 hydrocarbon refrigerant
- Door locks keeps drinks secure



Attention CA Residents PROP 65 WARNING

This product can expose you to chemicals, including lead, which are known to the State of California to cause cancer, birth defects, or other reproductive harm.

For more information, go to
www.P65warnings.ca.gov

MADE IN CHINA

CULITEK Back Bar Coolers-Std Depth Specifications

MBB-5928/MBB-5928G

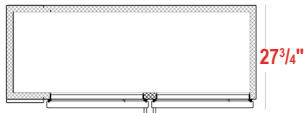
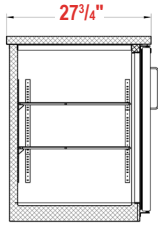
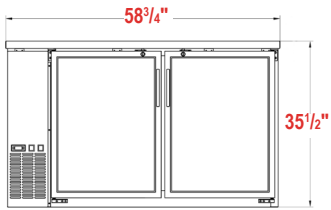

MBB-6928/MBB-6928G

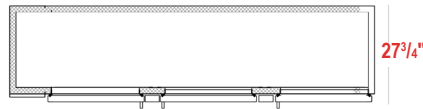
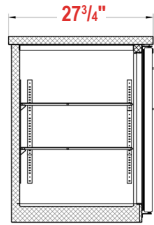
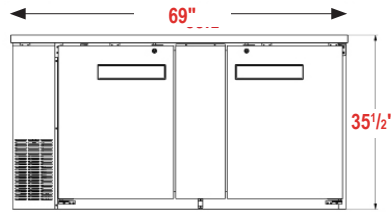

MBB-9028/MBB-9028G

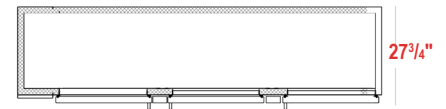
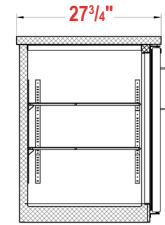
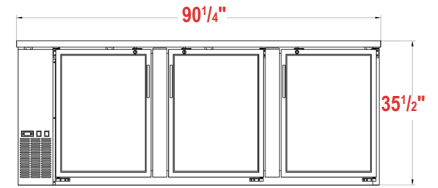

BACK BAR COOLERS - Standard Depth

Model Number	MBB-5928 MBB-5928G		MBB-6928 MBB-6928G		MBB-9028 MBB-9028G	
Doors	2		2		3	
Shelves	4		4		6	
Net Volume (Cu. Ft.)	19		23.3		32	
Overall Dimensions (in)	58.75"W x 27.75"D x 35.5"H		69"W x 27.75"D x 35.5"H		90.25"W x 27.75"D x 35.5"H	
Interior Dimensions (in)	48"W x 22.5"D x 33"H		48"W x 22.5"D x 33"H		77.8"W x 22.5"D x 30.5"H	
Horsepower	1/5		1/5		1/4	
Refrigerant	R290		R290		R290	
Voltage/Hertz/Phase	115/60/1		115/60/1		115/60/1	
Amps	2.8		3.6		4.7	
Net Weight (lbs)	229	258	280	295	370	386
Gross Weight (lbs)	273	302	324	365	414	430
Shipping Dimensions (in)	61.5"W x 30.5"D x 41.75"H		71.5"W x 30.5"D x 41.75"H		91.75"Wx30.5" x 41.75"H	
Half-Barrel Kegs (Cap)	2		3		4	
12 oz. Cans (Cap)	88 (6-packs)		112 (6-packs)		152 (6-packs)	