



Equipment That Dominates

FOR SERIOUS
CULINARY
PROFESSIONALS



It all starts with the ingredients.

We understand the importance of having reliable equipment in your operation. Our job is to provide equipment that puts your mind at ease so you can do what you do best, create!



CULITEK 

REFRIGERATION

**CULITEK, Commercial
Foodservice Equipment
You Can Count On!**

Back Bar Coolers Buying Guide



EQUIPMENT THAT DOMINATES



430 Stainless Steel
Exterior Construction



Environmentally Friendly R290
Hydrocarbon Refrigerant



Pre-Programmed
Digital Controls



MBB-5928G



MBB-7224

SS Series

INTERIOR CONSTRUCTION	All stainless steel interior, floor, and walls
SHELF INSTALLATION	Aluminum shelf support that are adjustable every 1/2"
SHELF CAPACITY	Adjustable heavy-duty, PVC coated wire shelves
TEMPERATURE RANGE	Digital temperature control ranges 33°F to 41°F
DOORS	Swing door-style with durable, solid black vinyl or glass door configurations, 12" long recessed handles, positive seal doors, with door locks on all models
AIR FLOW	Condensing unit located behind front grill and slides
AVAILABLE MODELS	Standard and narrow depth with solid or glass door configurations Standard depth: MBB-5928/5928G, MBB-6928/6928G, MBB-9028/9028G Narrow depth: MBB-4824/4824G, MBB-6024/6024G, MBB-7224/7224G

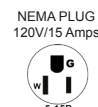

CULITEK Back Bar Coolers-Standard Depth

Models: MBB-5928, MBB-6928, MBB-9028
 MBB-5928G, MBB-6928G, MBB-9028G



MBB-6928



MBB-5928G

Back Bar Coolers-Standard Depth

Keep your drinks accessible with Back Bar Coolers from CULITEK. Designed for undercounter use or can double as a work surface. These standard depth coolers are available in solid or glass door configurations, offering great visibility and plenty of space to store your most popular brews! They are ideal for keeping beer "ice cold", until ready to serve! ETL Listed and ETL Sanitation, these units are backed with a 2-year warranty on parts and a 5-year warranty on the compressor. For areas where bar space is limited, narrow depth units also available.

Cooling System

- R290 hydrocarbon refrigerant is an environmentally-responsible choice for your business
- Condensing unit located behind front grill and slides out for easy cleaning
- Maintains a temperature range of 33°F to 41°F

Cabinet Construction

- Exterior is constructed of a durable black vinyl front and sides with an aluminum back
- Countertop is all stainless steel
- All stainless steel interior, floor, and walls
- Insulated cabinet with foamed-in-place, high density cell polyurethane insulation

Electrical Control

- Carel temperature controller initiates automatic defrost schedule for worry-free use
- 7-foot power cord with NEMA 5-15 plug

Door(s)

- Swing door-style solid black vinyl or with double pane thermal glass doors
- 12" long handles
- Positive seal doors
- Door locks on all models

Shelving

- Adjustable heavy-duty, PVC coated wire shelves
- Aluminum shelf support that are adjustable every 1/2"

Model Features

- Interior LED lighting provides greater visibility
- Stainless steel countertop is 1 1/2" thick

EQUIPMENT THAT DOMINATES
 For Culinary Professionals

STANDARD FEATURES

- 304 stainless steel top, interior walls, and floor
- Exterior constructed of black steel with an aluminum back
- Balanced refrigeration system maintains temperature range of 33°F to 41°F
- Adjustable heavy-duty, PVC coated wire shelves
- Swing door-style solid black vinyl or with double pane thermal glass doors
- Side mounted compressor
- Foamed-in-place insulation helps provide strength, while helping to maintain internal temperature
- Eco-friendly R290 hydrocarbon refrigerant
- Door locks keeps drinks secure



Attention CA Residents
PROP 65 WARNING
 This product can expose you to chemicals, including lead, which are known to the State of California to cause cancer, birth defects, or other reproductive harm.
 For more information, go to www.P65warnings.ca.gov

MADE IN CHINA

CULITEK Back Bar Coolers-Std Depth Specifications

MBB-5928/MBB-5928G

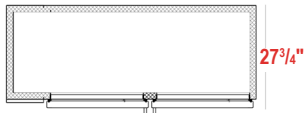
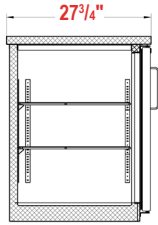
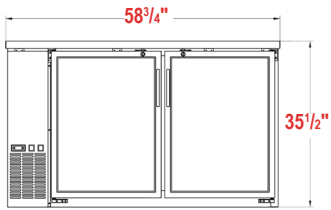

MBB-6928/MBB-6928G

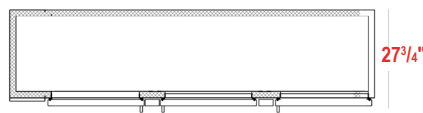
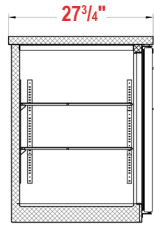
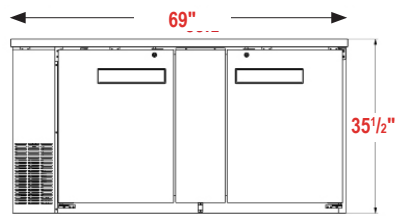

MBB-9028/MBB-9028G

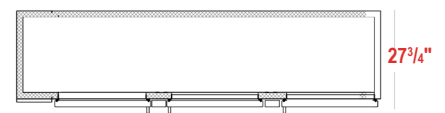
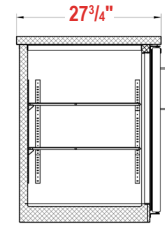
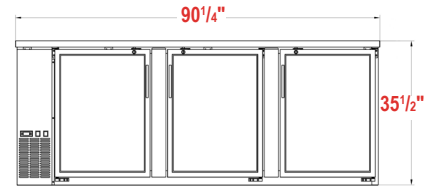

BACK BAR COOLERS - Standard Depth

Model Number	MBB-5928 MBB-5928G		MBB-6928 MBB-6928G		MBB-9028 MBB-9028G	
Doors	2		2		3	
Shelves	4		4		6	
Net Volume (Cu. Ft.)	19		23.3		32	
Overall Dimensions (in)	58.75"W x 27.75"D x 35.5"H		69"W x 27.75"D x 35.5"H		90.25"W x 27.75"D x 35.5"H	
Interior Dimensions (in)	48"W x 22.5"D x 33"H		48"W x 22.5"D x 33"H		77.8"W x 22.5"D x 30.5"H	
Horsepower	1/5		1/5		1/4	
Refrigerant	R290		R290		R290	
Voltage/Hertz/Phase	115/60/1		115/60/1		115/60/1	
Amps	2.8		3.6		4.7	
Net Weight (lbs)	229	258	280	295	370	386
Gross Weight (lbs)	273	302	324	365	414	430
Shipping Dimensions (in)	61.5"W x 30.5"D x 41.75"H		71.5"W x 30.5"D x 41.75"H		91.75"Wx30.5" x 41.75"H	
Half-Barrel Kegs (Cap)	2		3		4	
12 oz. Cans (Cap)	88 (6-packs)		112 (6-packs)		152 (6-packs)	

CULITEK Back Bar Coolers-Narrow Depth

Models: MBB-4824, MBB-6024, MBB-7224
 MBB-4824G, MBB-6024G, MBB-7224G



MBB-4824



MBB-7224G

Back Bar Coolers-Narrow Depth

Keep your drinks cold and accessible with Back Bar Coolers from CULITEK. Available in both solid and glass door, these 24" narrow depth units are ideal for establishments with a smaller work area. Designed for undercounter use or can double as a work surface, these coolers offer plenty of space to store your most popular brews! ETL Listed and ETL Sanitation, these units are backed with a 2-year warranty on parts and a 5 year warranty on the compressor. Also offered in standard depth configurations.

Cooling System

- R290 hydrocarbon refrigerant is an environmentally-responsible choice for your business
- Condensing unit located behind front grill and slides out for easy cleaning
- Maintains a temperature range of 33°F to 41°F

Cabinet Construction

- Exterior is constructed of a durable black vinyl front and sides with an aluminum back. Countertop is all stainless steel
- All stainless steel interior, floor, and walls
- Insulated cabinet with foamed-in-place, high density cell polyurethane insulation

Electrical Control

- Carel temperature controller initiates automatic defrost schedule for worry-free use
- 7-foot power cord with NEMA 5-15 plug

Door(s)

- Swing door-style with durable, solid black vinyl doors or with double pane thermal glass doors
- 12" long recessed handles
- Positive seal doors
- Door locks on all models

Shelving

- Adjustable heavy-duty, PVC coated wire shelves
- Aluminum shelf support that are adjustable every 1/2"

Model Features

- 24" narrow depth is great for areas with limited bar space.
- Interior LED lighting provides greater visibility
- Stainless steel countertop is 1 1/2" thick

EQUIPMENT THAT DOMINATES
 For Culinary Professionals

STANDARD FEATURES

- 304 stainless steel top, interior walls, and loor
- Exterior constructed of black steel with an aluminum back
- The narrow depth of 24" is ideal for areas where bar space is limited.
- Balanced refrigeration system maintains temperature range of 33°F to 41°F
- Adjustable heavy-duty, PVC coated wire shelves
- Swing door-style solid black vinyl or with double pane thermal glass doors
- Side mounted compressor
- Foamed-in-place insulation helps provide strength, while helping to maintain internal temperature
- Eco-friendly R290 hydrocarbon refrigerant
- Door locks keeps drinks secure



Attention CA Residents
PROP 65 WARNING
 This product can expose you to chemicals, including lead, which are known to the State of California to cause cancer, birth defects, or other reproductive harm.
 For more information, go to www.P65warnings.ca.gov

MADE IN CHINA



Back Bar Coolers-Narrow Depth Specifications

MBB-4824/MBB-4824G

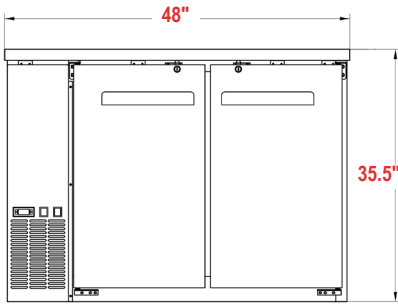

MBB-6024/MBB-6024G

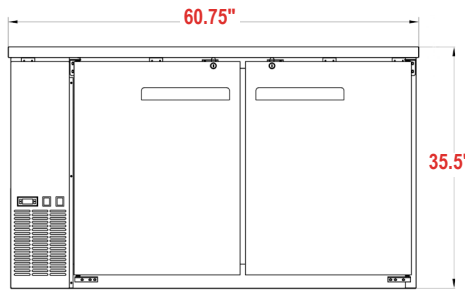

MBB-7224/MBB-7224G

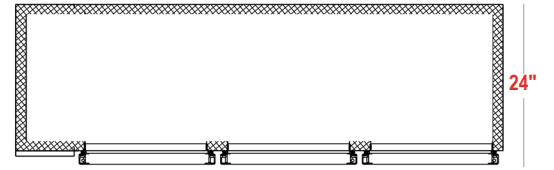
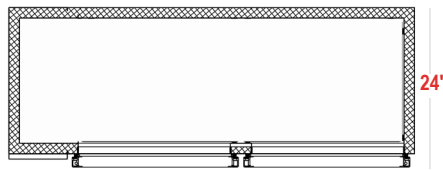
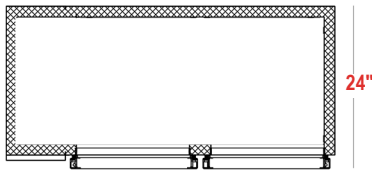
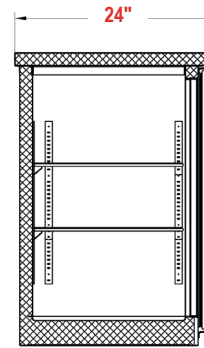
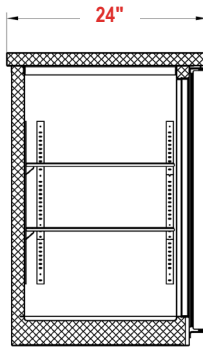
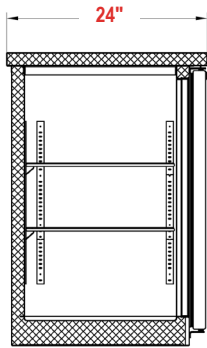
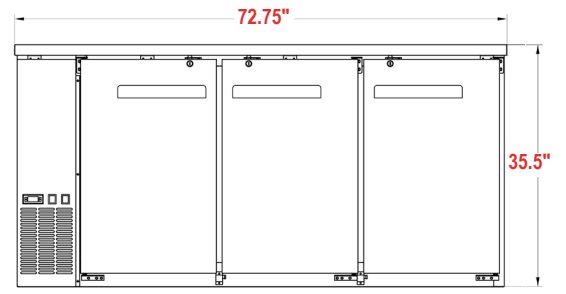

BACK BAR COOLERS-NARROW DEPTH

Model Number	MBB-4824 MBB-4824G		MBB-6024 MBB-6024G		MBB-7224 MBB-7224G	
Doors	2		2		3	
Shelves	4		4		6	
Net Volume (Cu. Ft.)	11.8		15.8		19.6	
Overall Dimensions (in)	48"W x 24"D x 35.5"H		60.75"W x 24"D x 35.5"H		72.75"W x 24"D x 35.5"H	
Interior Dimensions (in)	36"W x 18.5"D x 29"H		48"W x 18.5"D x 29"H		60"W x 18.5"D x 29"H	
Horsepower	1/5		1/4		1/4	
Refrigerant	R290		R290		R290	
Voltage/Hertz/Phase	115/60/1		115/60/1		115/60/1	
Amps	2.88		2.88		3.96	
Net Weight (lbs)	187	216	247	260	309	311
Gross Weight (lbs)	231	260	291	304	353	355
Shipping Dimensions (in)	51"W x 27.5"D x 41"H		63"W x 27.5"D x 41"H		75"W x 27.5"D x 41"H	
Half-Barrel Kegs (Cap)	2		2		3	
12 oz. Cans (Cap)	48 (6-packs)		72 (6-packs)		76 (6-packs)	