



High Speed Combination Oven Culitek ACE14VCT & ACE19VCT Models

Combines cooking energies for superior baking results *FAST!*

- 2700W Convection enhances toasting and browning
- 95°– 250°C (200°– 475°F) temperature range
- 1000, 1400, or 1900W top antenna feed microwave system heats quickly, reduces cooking time
- Flexible cooking platform. Use any combination of convection and microwave

Simplifies cooking

- *Ventless!* built-in catalytic converter for ventless operation
- Stackable without a kit, to increase throughput and save valuable counter space
- 34 liter (1.2 cubic ft.) oven capacity easily accommodates a 30cm (12") pizza

Multi-language universal operation, with programming flexibility

- Oven interface and programming software support 20 languages
- Smart USB connectivity standard
- Stores up to 100 programmable menu items

Cuts Costs

- Uses less energy than a conventional oven
- Eliminates need for pre-cooking and holding
- Uses quarter-size metal trays, pans and screens

Easy to Use and Maintain

- Stainless steel exterior and interior
- Door opens 90°+ for full access to the oven cavity

This high speed oven is ideal for...

Applications

- Cafés
- Bakeries
- Wine bars
- Pubs
- Supermarkets
- Convenience stores
- Country clubs
- Kiosks

Throughput potential by oven wattage (Qty/hour)

Food item	1400W	1900W
Lava Cake	36	36
Chicken Pot Pie	15	19
Biscuits (6)	14	14
Scones	16	18
Baked Brie	14	16
Artichoke Dip	25	27
30cm (12") Pizza	12	15
Large Baked Potato	9	11

Location of Oven(s)

- Kitchen shelf
- Kitchen counter top, single or stacked
- Equipment stand, single or stacked

Service

All products are backed by Culitek
Commercial Service

Warranty

Warranty Certificate for this product can be found on
the Culitek. website at culitekequipment.com

Safety and Sanitation

This product meets and exceeds safety and sanitation
standards set for commercial microwave ovens by UL, ETL, NSF,
CSA, and FDA



Commercial Service
800-436-9472



Culitek ACE14VCT & ACE19VCT Models | High Speed Combination Oven

front view

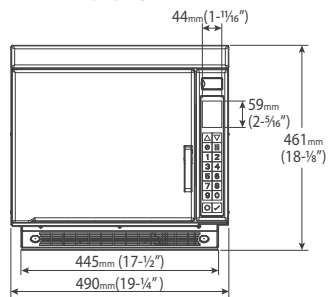

side view

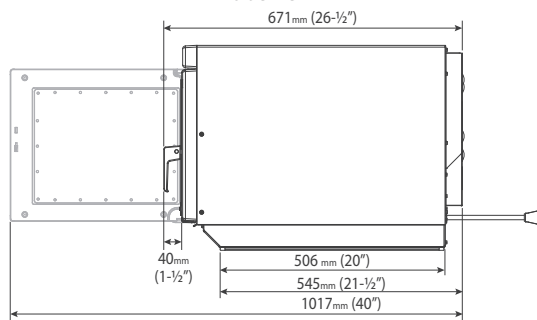

back view

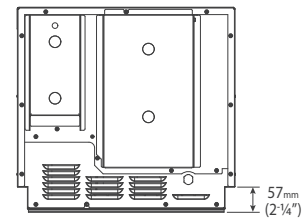

Dimensions

Exterior	H 461 (18 1/8")	W 490 (19 1/4")	D† 671 (26 1/2")
Cavity	H 267 (10 1/2")	W 330 (13")	D 381 (15")
Usable Cavity Space	34 liter (1.2 cubic ft.)		
Door Depth	1017 (40"), 90°+ door open		
Installation Clearance	Top: 102 (4")	Sides: 25 (1")	Back: None
Shipping Carton	H 546 (21 1/2")	W 540 (21 1/4")	D 756 (29 3/4")
Weight			
Product Weight	51 kg. (112 lbs)		
Ship weight (approx.)	53 kg. (116 lbs)		

Features

Configuration	Countertop
Stackable	Yes, without kit
Display	71 (2.8") Color LCD
USB Port	Yes
Internet Connectivity	No
Control System	Touchpad
Programmable Control	Yes, 10 pads
Braille	No
Settings Programmable	100
Temperature Range	95°– 250°C (200°– 475°F)
Microwave Distribution	Rotating antennas, top
Power Levels	11
Defrost	Yes, microwave only, power level 2
Time Entry Option	Yes
Stage Cooking	Yes, 4 stages
Air Filter	Non-removable with cleaning reminder
Rack	2 positions, 1 removable rack
Door Handle	Lift & Pull
Exterior Finish	Stainless steel
Interior Finish	Stainless steel

Culitek requires installing a type D circuit breaker for all high-speed oven installations.

Measurements are millimeters. Measurements in () are US Standard

* IEC 60705 Tested

† Includes handle

‡ Catalytic convertor filters grease and odors from the air. This product conforms to the Ventless Operation Recommendations set forth by NFPA96 using EPA202 test method

Electrical Configuration

Region	Model#/ UPC	Auto. Voltage Sensor	Max. Cooking Time	Catalytic Converter	Power Consumption	Power Output		Power Source	Plug Configuration	Cord Length	Frequency	Magnetron
North America single phase	ACE14VCT 810081733731	Yes	20:00	Yes‡	3200W, 16A	1400W*	2700W	208/240V, 60Hz, 20A, single phase	NEMA 6-20	1.5m (5 ft.)	2450MHz	2
North America single phase	ACE19VCT 810081733748	Yes	16:00	Yes‡	5300W, 26A	1900W*	2700W	208/240V, 60Hz, 30A, single phase	NEMA 6-30	1.5m (5 ft.)	2450MHz	2

Updated 08/27/2021